

# BRITONY II.T

Nat - G.C. N° 52 980 04

LPG - G.C. N° 52 980 09

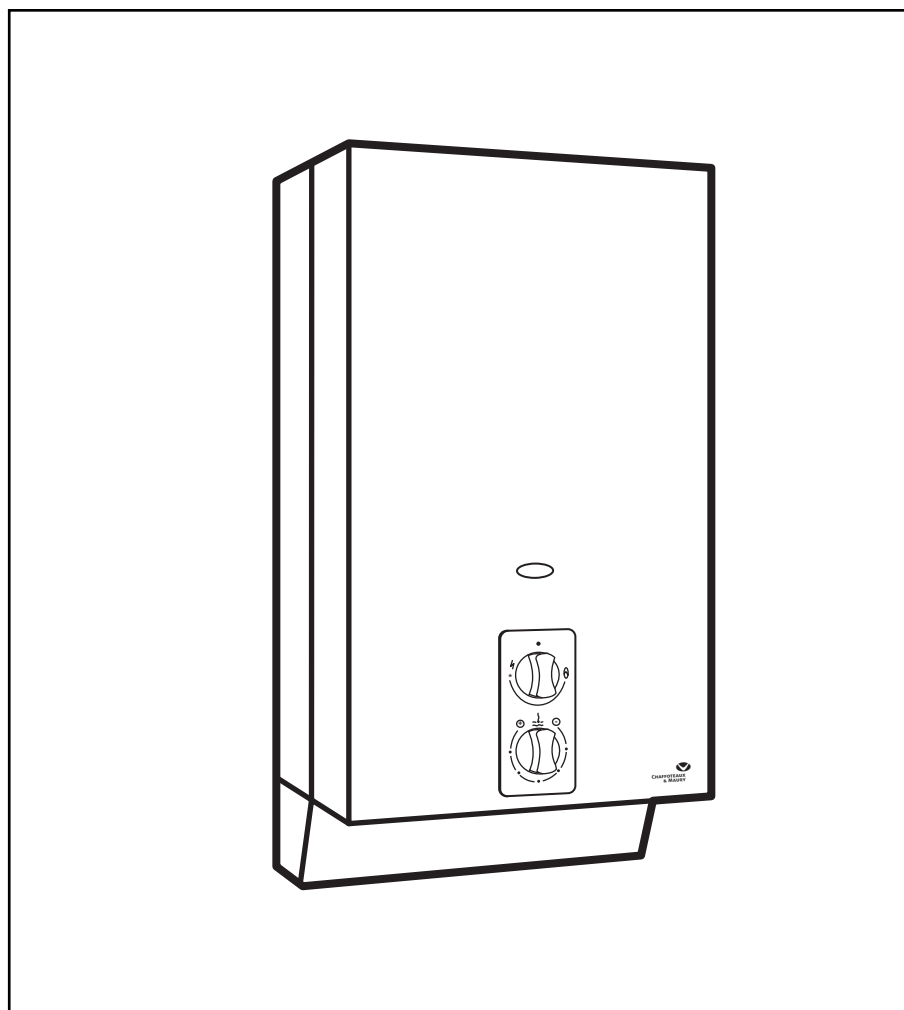

---

## instructions for use

### Remove protective film before use

*Purpose provided room ventilation is not required since the air for the burner is taken from outside the house. The flue goes directly through the wall behind the heater*

### GAS SAFETY INSTALLATION AND USE REGULATIONS

*It is the law that all gas appliances are installed by competent persons in accordance with the above regulations. Failure to install appliances correctly could lead to prosecution.*

*It is in your own interest and that of safety to ensure compliance with the law.*

**CONFORMS WITH EUROPEAN STANDARD E N 26**



**CHAFFOTEAUX  
& MAURY**

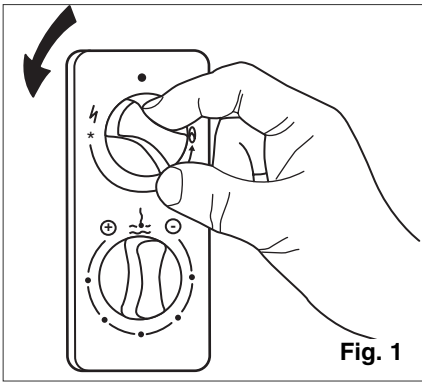

Fig. 1

## TO LIGHT THE HEATER

- 1) (fig. 1) With all hot taps closed, light the heater by turning the gas control knob to the position marked ☆. If the pilot, which can be seen through the window, does not light, leave the knob in this position for a few moments. Return the knob to the «off» position «●» and repeat.
- 2) When the pilot is alight, wait 10 seconds then turn the gas control knob slowly to the full gas position (fig. 2).

The heater is now ready for use, and will light when a hot tap is opened.

If the pilot goes out, repeat operations 1 and 2. When the control knob is turned back to the «off» position, it may not be possible to turn it immediately to the pilot position - if so, wait 30 seconds for the safety device to reset itself.

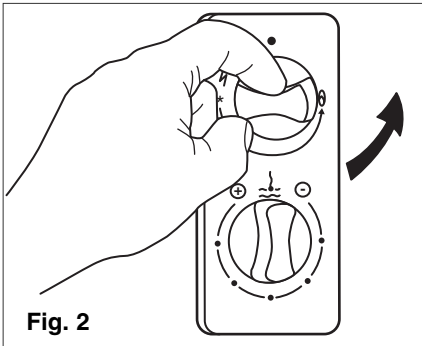

Fig. 2

## TO TURN OFF THE PILOT

If the heater is not required to be used for some time, the pilot can be turned off. Turn the control knob clockwise to the position as shown in fig. 3.

## USING THE HEATER

Light the pilot as previously described and turn the gas control knob to the position shown in fig. 2. Turn on a hot water tap.

Adjust the lower control knob on the water heater to the required temperature. Turning it anti-clockwise to the position shown in fig. 4 will give a lower water temperature.

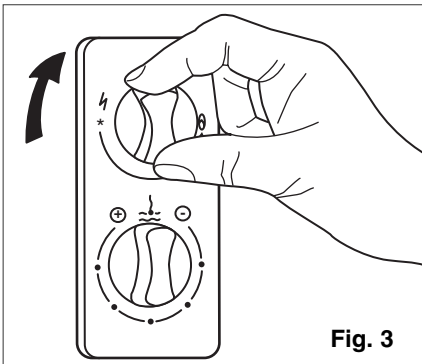

Fig. 3

## FROST PRECAUTIONS

If there is any risk of freezing, the heater should be drained.

- 1) Turn off the pilot.
- 2) Turn off the cold water supply to the heater with the tap fitted below (A) (fig. 5). Slide the plastic trim forward to improve access.
- 3) Open an adjacent hot water tap.
- 4) Remove the drain plug (B) (fig. 5), and drain the water into a basin.

To restart the heater replace the drain plug and open the cold water supply tap. Check that water flows through the heater before lighting the pilot.

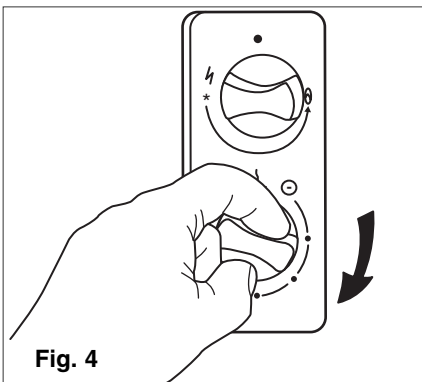

Fig. 4

## SERVICE

**To ensure that the heater continues to work efficiently and has a long life, it is important that it is serviced annually. Ask your installer or BRITISH GAS for details of a regular service scheme, or your local Chaffoteaux et Maury service centre.**

**This water heater has been tested and approved by British Gas to the relevant British Standards.**

**This water heater is suitable for use with showers and automatic washing machines.**

**For further information, ask your installer or contact Chaffoteaux et Maury Limited.**

Chaffoteaux & Maury are continuously improving their products and therefore reserve the right to change specifications without prior notice and accepts no liability for any errors or omission in the information contained in this document.

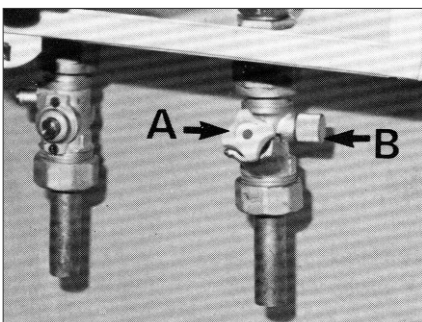

Fig. 5

Manufacturer: **Chaffoteaux & Maury - France**

Commercial subsidiary: **MTS (GB) Limited**  
 MTS Building  
 Hughenden Avenue  
 High Wycombe  
 Bucks HP13 5FT  
 Telephone: (01494) 755600  
 Fax: (01494) 459775  
 internet: [www.chaffoteaux.co.uk](http://www.chaffoteaux.co.uk)  
 E-mail: [info@mtsgb.ltd.uk](mailto:info@mtsgb.ltd.uk)  
**Technical Support Help Line: (01952) 222288**